

5th/6th Gear



Installation

NOTE: Replace all locknuts and spring pin.

1. Reassemble the parts following the numbered sequence.

	Bolt Size	Torque Value	
A	6 x 1.0 mm	12 N·m (1.2 kg-m, 9 lb-ft)	(24)

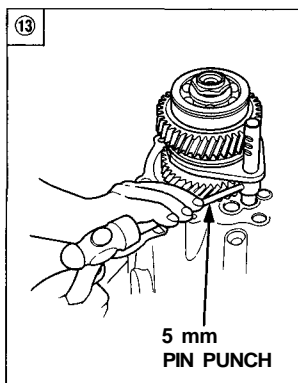
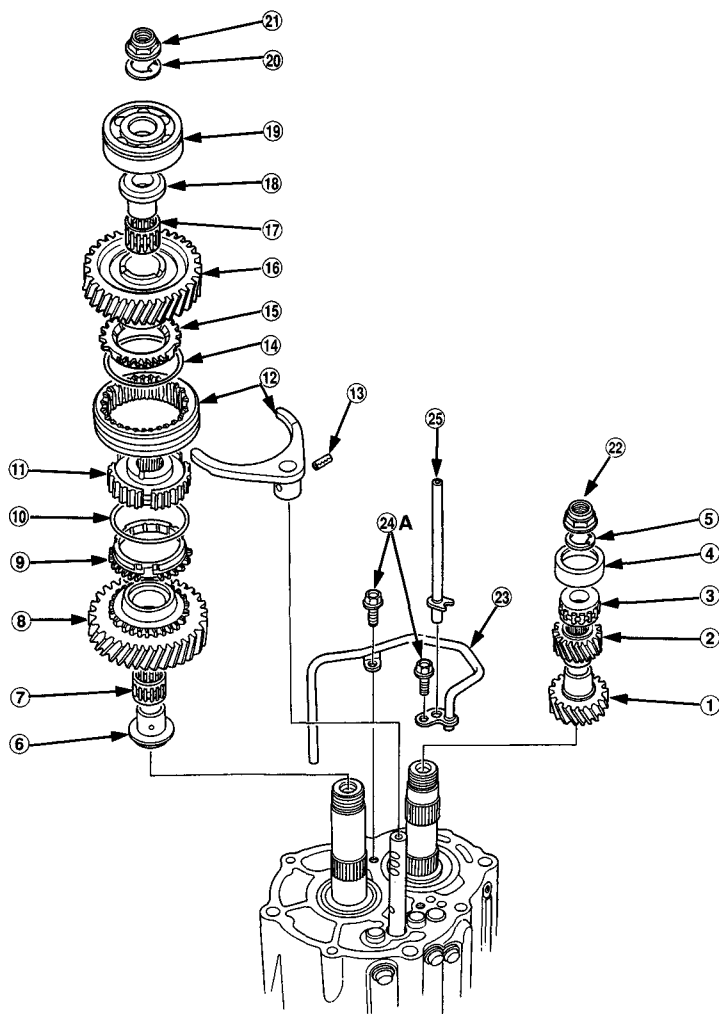

(21) (22)

- 1. Install the special tool.

MAINSHAFT HOLDER
07924-PJ4010A

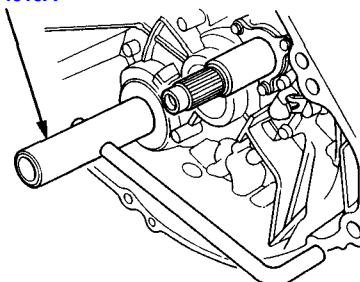

- 2. Tighten the locknut, then stake the locknut tab into the groove.
NOTE: Countershaft locknut has left-hand threads.

LOCKNUT:
MAINSHAFT:

185 → 0 → 185 N·m
(18.5 → 0 → 18.5 kg-m, 134 → 0 → 134 lb-ft)

COUNTERSHAFT:

165 → 0 → 165 N·m
(16.5 → 0 → 16.5 kg-m, 119 → 0 → 119 lb-ft)

LOCKNUT
Replace.
SPRING WASHER

